

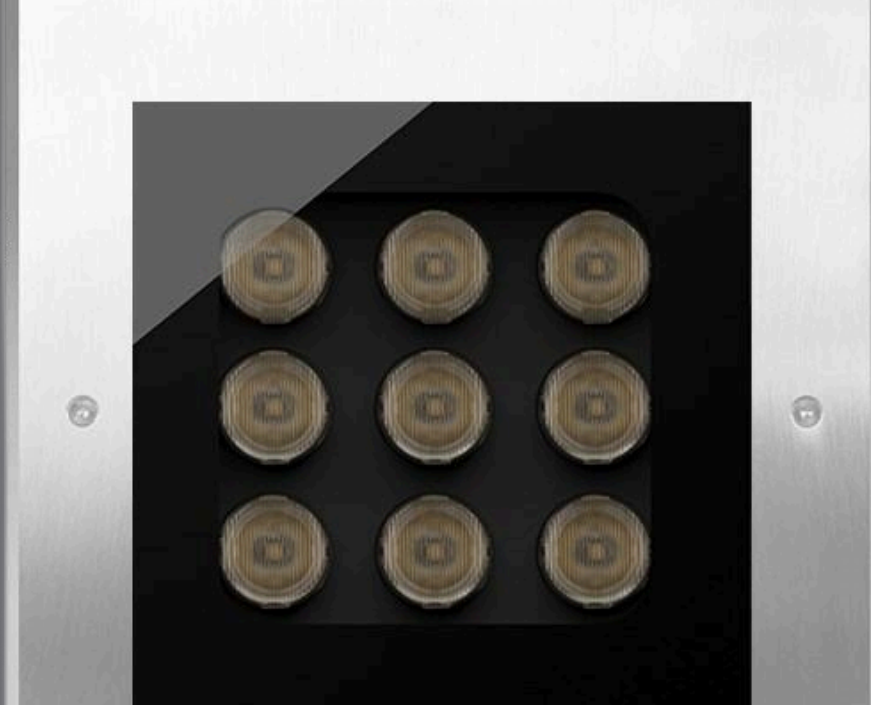

BUNNY HOP



INSTALLATION TYPE:
RECESSED



INSTALLATION INSTRUCTION

02/11/2026



BUNNY HOP

02/11/2026

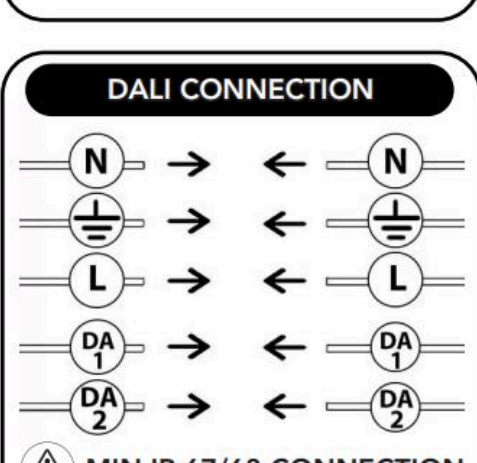
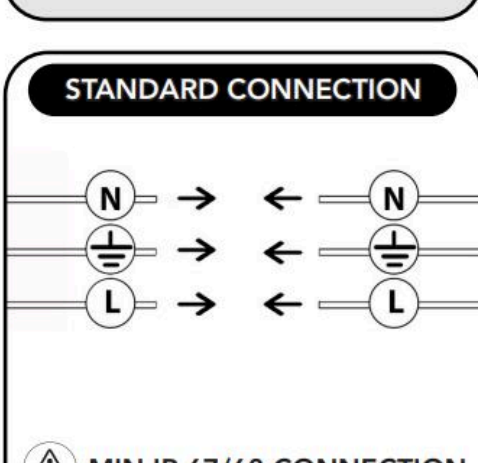
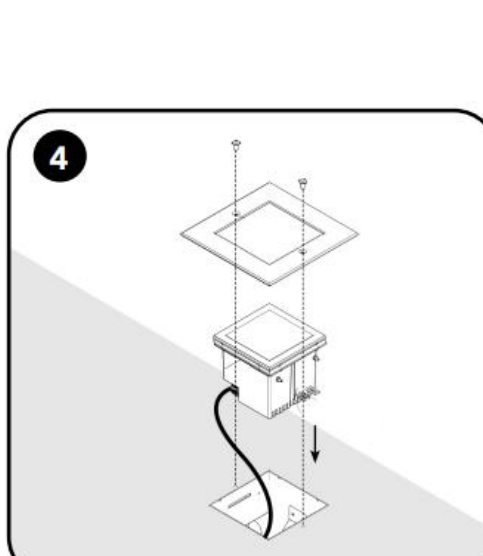
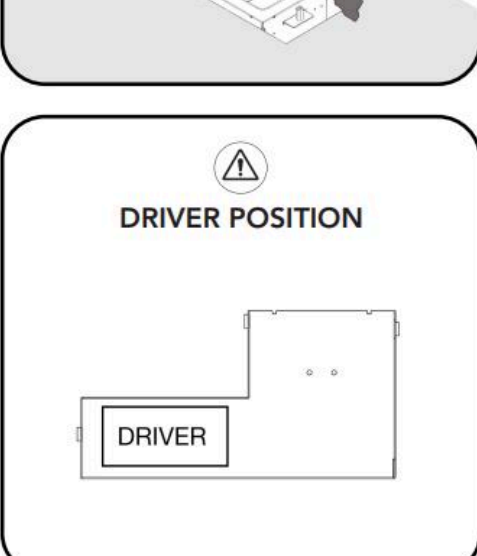
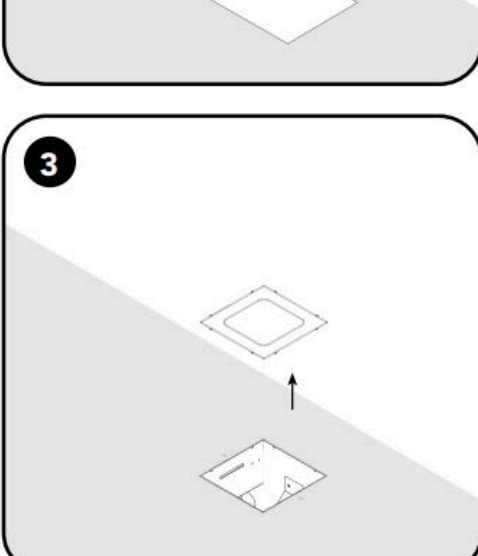
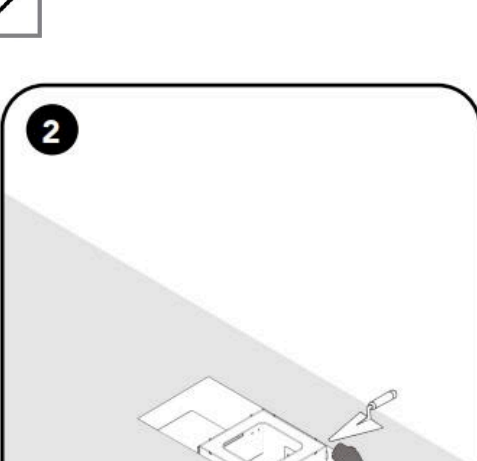
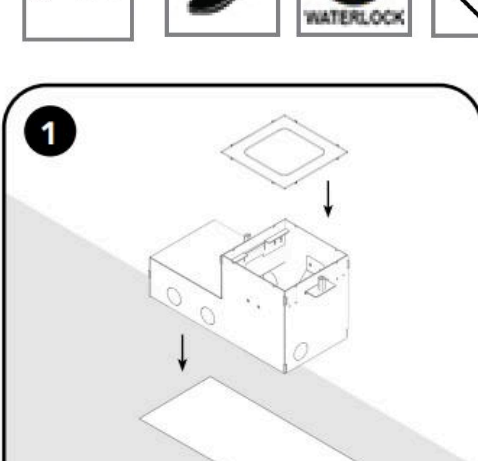

MIN IP 67/68 CONNECTION

MIN IP 67/68 CONNECTION

P.2

sales@gordonbullard.com
www.bullardbollards.com
1 877-964-4646



991 South Gull Lake Dr.
Richland, MI 49083
USA

Due to the dynamic nature of lighting products and the associated technologies, luminaire data on all specification sheets is subject to change at the discretion of Gordon Bullard LLC and associated companies.

© Bullard & Comany 2024 All Rights Reserved



BUNNY HOP

02/11/2026



IT Spegner l'alimentazione
EN Switch-off the power supply
FR Coupez l'alimentation électrique
DE Schalten Sie die Stromversorgung aus
ES Desconectar la alimentación
PT Desligar a fonte de alimentação
RU Отключите источник питания
AR إيقاف التيار الكهربائي

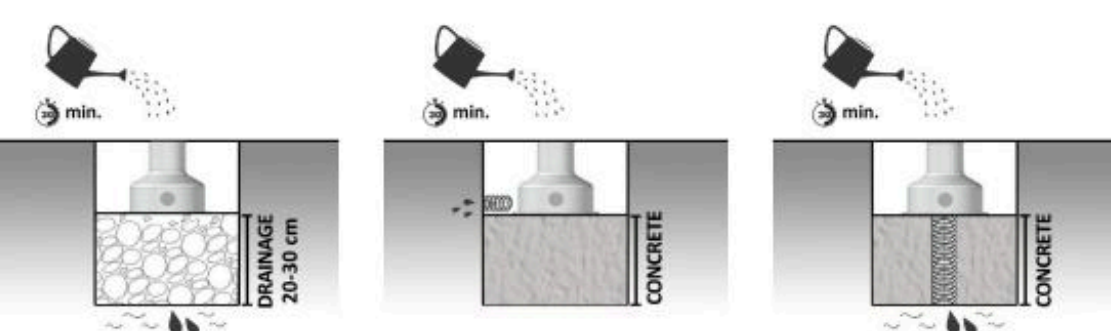
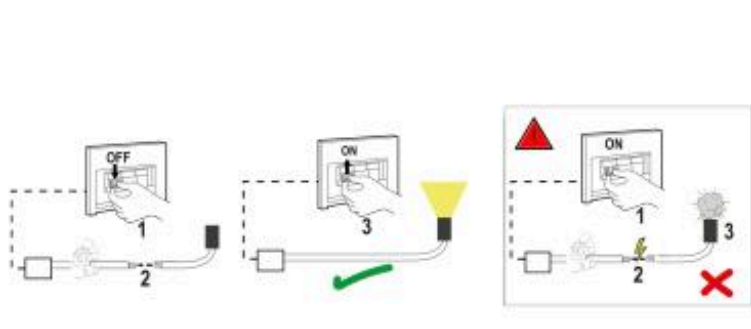

IT Se l'acqua non scompare in 30 min. Utilizzare un sistema di drenaggio supplementare
EN If the water does not disappear in 30 min. Use an additional drainage system
FR Si l'eau ne disparaît pas en 30 min. Utilisez un système de drainage supplémentaire
DE Wenn das Wasser nicht innerhalb von 30 min. verschwindet. Verwenden Sie ein zusätzliches Drainagesystem
ES Si el agua no desaparece en 30 min. Utilice un sistema de drenaje adicional
PT Se a água não desaparecer em 30 min. Utilizar um sistema de drenagem adicional
RU Если вода не исчезает через 30 мин. Используйте дополнительную дренажную систему
AR في غضون 30 دقائق من فحص ما إذا كان قد جف. استخدم نظام تصريف إضافي.

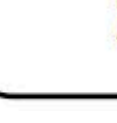

P.3

sales@gordonbullard.com
www.bullardbollards.com
1 877-964-4646



991 South Gull Lake Dr.
Richland, MI 49083
USA

Due to the dynamic nature of lighting products and the associated technologies, luminaire data on all specification sheets is subject to change at the discretion of Gordon Bullard LLC and associated companies.

© Bullard & Comany 2024 All Rights Reserved



BUNNY HOP

02/11/2026



IT Istruzioni fine vita e smaltimento dei componenti
EN End-of-life instructions and disposal of components
FR Instructions de fin de vie et élimination des composants
DE Anweisungen für das Ende der Lebensdauer und die Entsorgung von Komponenten
ES Instrucciones de fin de vida útil y eliminación de componentes
PT Instruções de fim de vida útil e eliminação de componentes
RU Инструкции по окончании срока службы и утилизации компонентов
AR تعليمات نهاية العمر الافتراضي واستخدام المنتج

IT Spegnimento: interrompere l'alimentazione dell'apparecchio
EN Switch-off the power supply to the device
FR Fermeture: interruption de l'alimentation électrique de l'appareil
DE Abschaltung: Unterbrechung der Stromzufuhr zum Gerät
ES Cierre: interrupción de la alimentación eléctrica del aparato
PT Encerramento: Interrupção da alimentação elétrica do aparelho
RU Выключение: Прерывание подачи питания на устройство
AR إيقاف التيار الكهربائي عن الجهاز

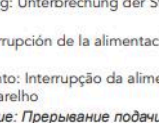

IT Rimuovere la lampada
EN Removing the lamp
FR Retrait de la lampe
DE Abnehmen der Lampe
ES Retirar la lámpara
PT Remoção da lâmpada
RU Снятие лампы
AR إزالة المصباح

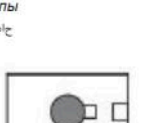

IT Rimuovere la batteria
EN Remove the battery
FR Retirer la batterie
DE Entfernen Sie die Batterie
ES Retirar la batería
PT Retirar a bateria
RU Извлечь батарею
AR إزالة البطارية

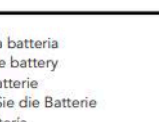

IT Rimuovere l'apparecchio
EN Removing the device
FR Retirer l'appareil
DE Entfernen Sie das Gerät
ES Retirar el dispositivo
PT Retirar o dispositivo
RU Извлечь устройство
AR إزالة الجهاز



IT Inviare i materiali ad un centro di raccolta RAEE
EN Send materials to a collection centre WEEE
FR Envoyer des matériaux à un centre de collecte DEEE
DE Senden Sie Materialien an eine Sammelstelle WEEE
ES Enviar materiales a un centro de recogida RAEE
PT Enviar materiais para um centro de recolha WEEE
RU Отправить материалы в центр сбора WEEE
AR إرسال المواد إلى مركز جمع النفايات الإلكترونية WEEE

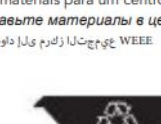

THE SAFETY OF THIS FIXTURE IS GUARANTEED ONLY IF YOU COMPLY WITH THESE INSTRUCTIONS; REMEMBER TO KEEP IN A SAFE PLACE. THE APPLIANCE MUST NOT BE TAMPERED WITH OR TRANSPORTED AND IT MUST BE INSTALLED AND USED AS SUPPLIED AND IN COMPLIANCE WITH THE NATIONAL RULES ON INSTALLATIONS. SWITCH-OFF THE POWER SUPPLY BEFORE CARRYING OUT ANY MAINTENANCE OPERATIONS. HOT PLUG-IN IS NOT ALLOWED AND MAY CAUSE DAMAGE TO THE LUMINAIRE. THE LIGHT SOURCE CONTAINED IN THIS LUMINAIRE SHALL BE REPLACED ONLY BY THE MANUFACTURER OR HIS SERVICE AGENT. INSTALLATION AND SERVICE MUST BE PERFORMED BY QUALIFIED SERVICE PERSONNEL. ANY NON-COMPLIANT INSTALLATIONS WILL INVALIDATE ALL FORMS OF GUARANTEE.

P.4

sales@gordonbullard.com
www.bullardbollards.com
1 877-964-4646



991 South Gull Lake Dr.
Richland, MI 49083
USA

Due to the dynamic nature of lighting products and the associated technologies, luminaire data on all specification sheets is subject to change at the discretion of Gordon Bullard LLC and associated companies.

© Bullard & Comany 2024 All Rights Reserved