



**BULLARD
BOLLARDS**
Think Bollard Think Bullard

BENDA

Recessed Wall Luminaires Round / Square





FIXTURE TYPE: _____

PROJECT NAME: _____

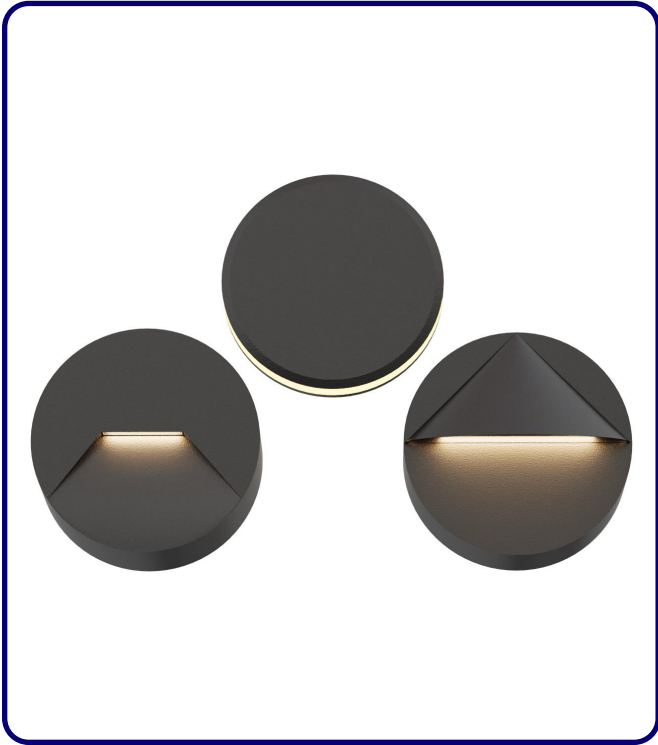

*CABLE GLAND - IP66

GENERAL INFORMATION:

The BENDA Recessed Wall Luminaire is a sleek and durable LED fixture ideal for round and square wall applications. Built from die-cast powder-coated aluminum with a UV-stable, fireproof PC lens, it provides efficient illumination on 110–277V while ensuring lasting performance. With an IP65 weatherproof and IK08/IK09 impact-resistant rating, BENDA withstands demanding environments and supports loads over 2000 kg. Available in Sanded Dark Gray, Sanded Black, and Sanded White finishes, it combines modern design with reliable functionality for stairways, pathways, and architectural lighting.

FIXTURE TYPE:

Recessed Wall Luminaires - Round / Square

LIGHTING:

LED

LED

VOLTAGE:

110-277V

110-277V

MATERIAL:

12# Die-casting powder coated aluminum

LENS:

UVstop & Fireproof PC T=1 mm

RECESSED SLEEVE:

PC/ABS ALLOYS 148#

LOADING CAPACITY:

>2000kg

IP RATING:

IP 65

IP65

IK RATING:

IK 08 / IK 09

FINISHING:

Sanded Dark Gray
Sanded Black
Sanded White

sales@gordonbullard.com
www.bullardbollards.com
1-877-964-4646



991 South Gull Lake Dr
Richland, MI 49083
USA



FIXTURE TYPE: _____

PROJECT NAME: _____

NOTES:

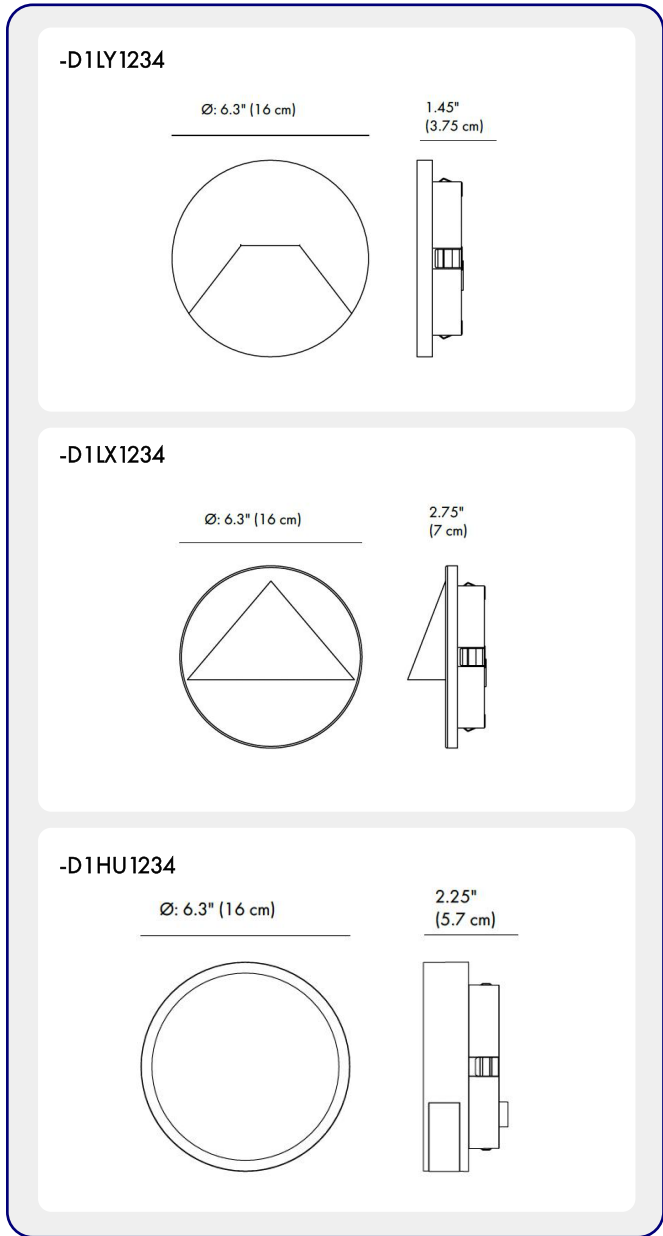

HOW TO ORDER:

CODE:

Example:
 CODE: BB-BND-KPG-RWL-XXX-XXX-XXX-XXX-XXX-XX

BB-BND-KPG-RWL-
 D1LY1234-K30-
 KAP7037-DIM

1 MODELS:

CODE -D1LY1234

DIMENSIONS:

Diameter - Ø: 6.3" (16 cm)
 Depth - P: 1.45" (3.75 cm)

LIGHT SOURCE:

LED / 12 x 0.5W / 250 mA / 134 lm / 110-277V / IK 09

CODE -D1LX1234

DIMENSIONS:

Diameter - Ø: 6.3" (16 cm)
 Depth - P: 2.75" (7 cm)

LIGHT SOURCE:

LED / 12 x 0.5W / 330 mA / 226 lm / 110-277V / IK 08

CODE -D1HU1234

DIMENSIONS:

Diameter - Ø: 6.3" (16 cm)
 Depth - P: 2.25" (5.7 cm)

LIGHT SOURCE:

LED / 12 x 0.5W / 250 mA / 127 lm / 110-277V / IK 08

2 CCT OPTIONS:

-K30 3000K
 -CUS Custom on request*

3 FINISH OPTIONS:

-KAP7037 Sanded Dark Gray
 -RAL 9005 Sanded Black
 -RAL9003 Sanded White

4 DIMMING OPTIONS:

-DIM 1-10V
 -PWM Pulse Width Modulation
 -DALI DALI (Digital Addressable Lighting Interface)

sales@gordonbullard.com
 www.bullardbollards.com
 1-877-964-4646



991 South Gull Lake Dr
 Richland, MI 49083
 USA

FIXTURE TYPE: _____

PROJECT NAME: _____

NOTES:

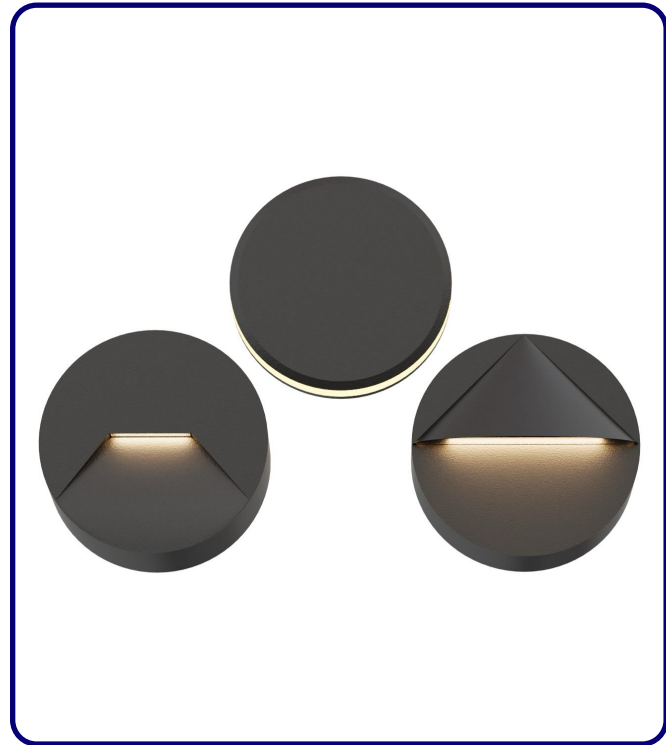

*CABLE GLAND - IP66

HOW TO ORDER:

CODE:

Example:
CODE: BB-BND-KPG-RWL-XXX-XXX-XXX-XXX-XXX-XX

BB-BND-KPG-RWL-
D1LY1234-K30-
KAP7037-DIM

5 RECESSED SLEEVE: (included)

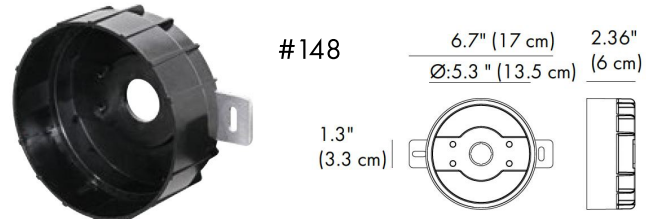

6 FEATURES:



Front cover without screws

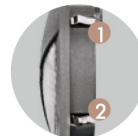

Use the high-strength clips for installation and fixation. (please refer remark 1 & 2)

7 DIAGRAM OF INSTRUCTION:

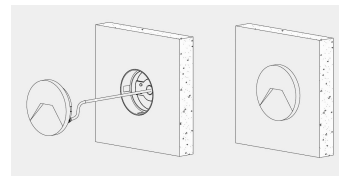

8 PHOTOMETRIC INFO:

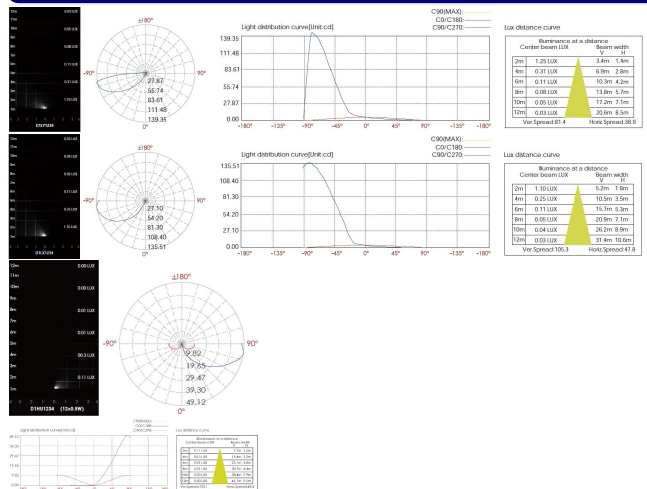

sales@gordonbullard.com
www.bullardbollards.com
1-877-964-4646



991 South Gull Lake Dr
Richland, MI 49083
USA